

Directions from Hayward City Hall to Alameda County's Public Works Building

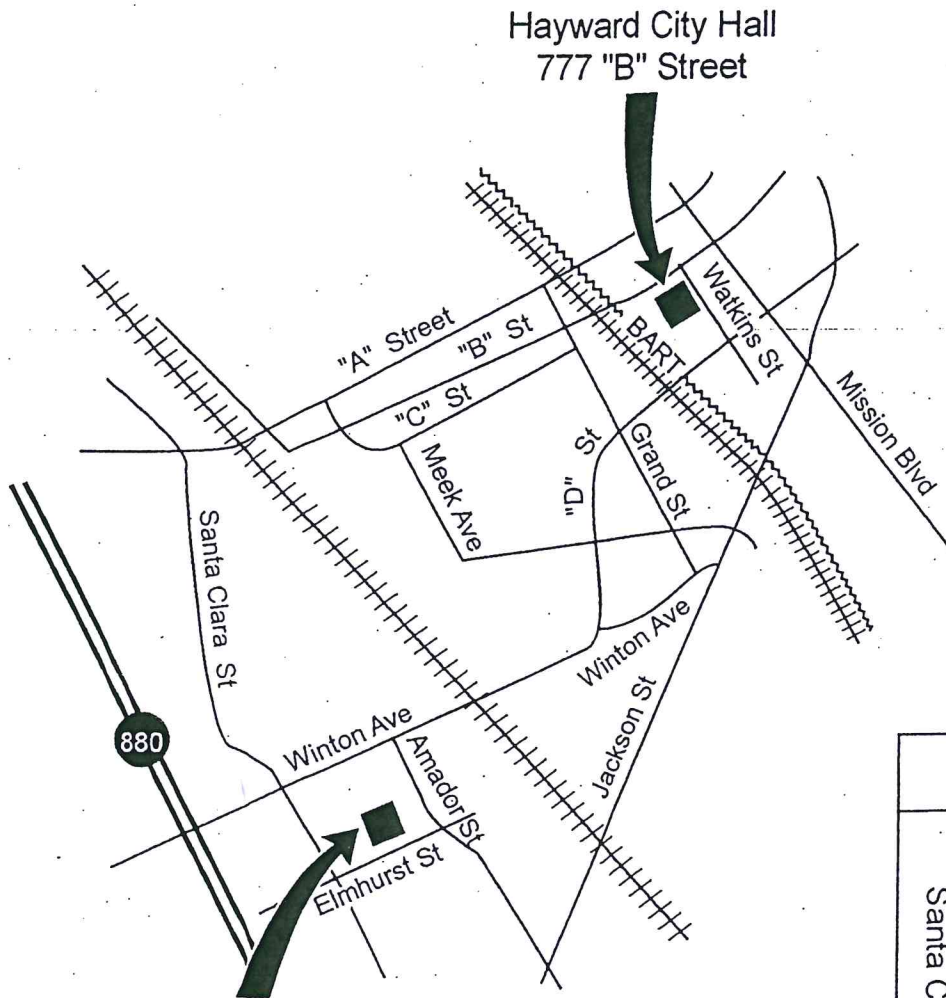

Alameda County
Public Works Bldg
399 Elmhurst Street
Tel: (510) 670-5400

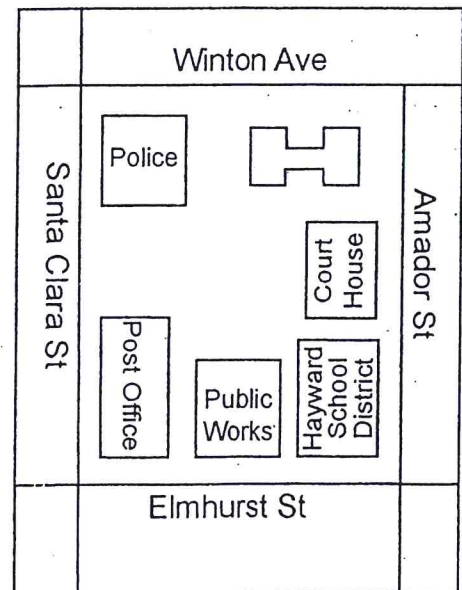

Alameda Public Works Building:

Building Inspection, 399 Elmhurst St, Tel: 670-5440

Business License, 224 W. Winton Ave, Tel: 670-6400

Planning Department, 399 Elmhurst St, Tel: 670-5400